

Unfixed Bearings — Cylindrical Outside Diameter — Hex Bore

Non-Relubricate — Triple lip seals

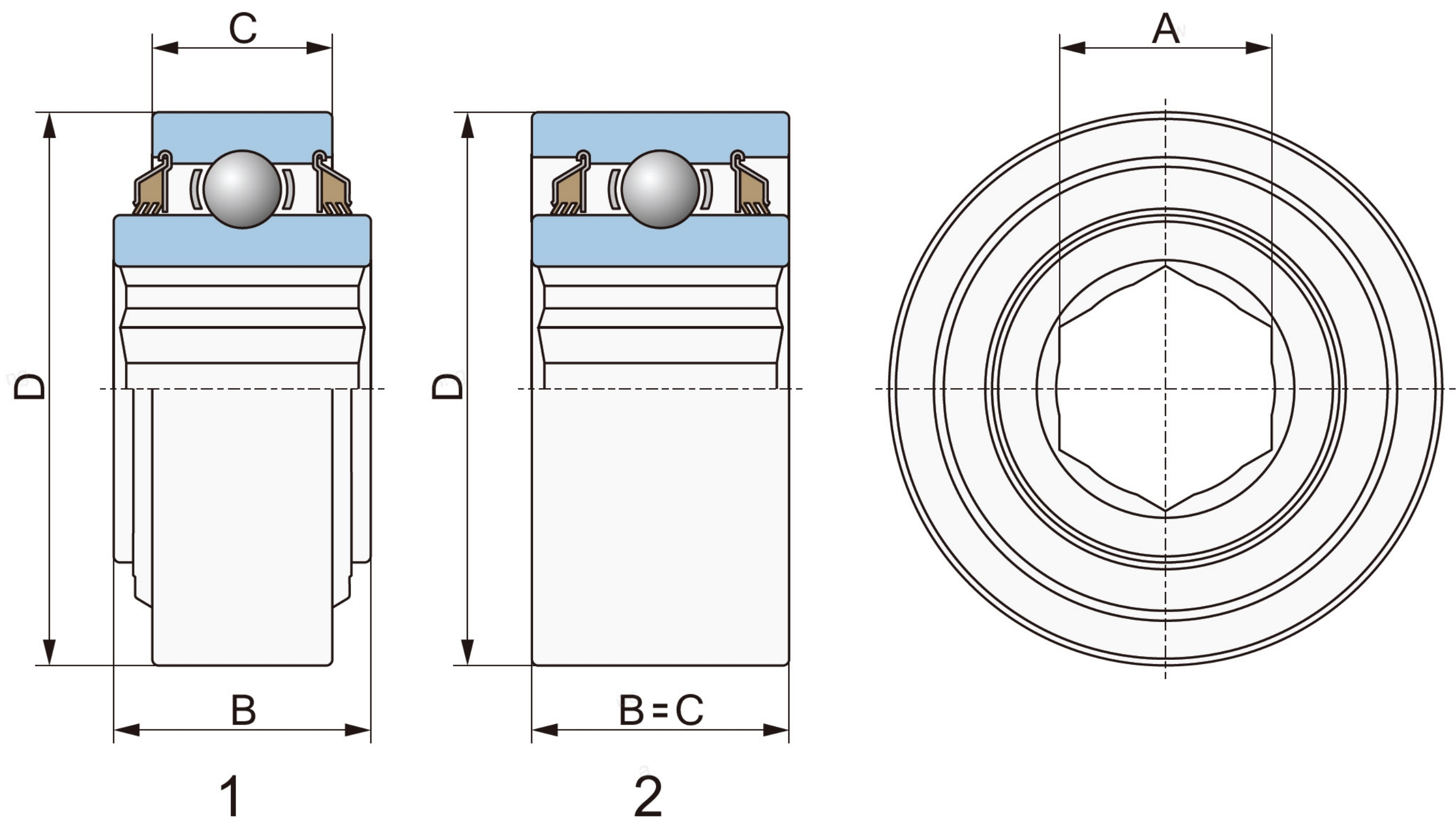

Relubricate — Triple lip seals

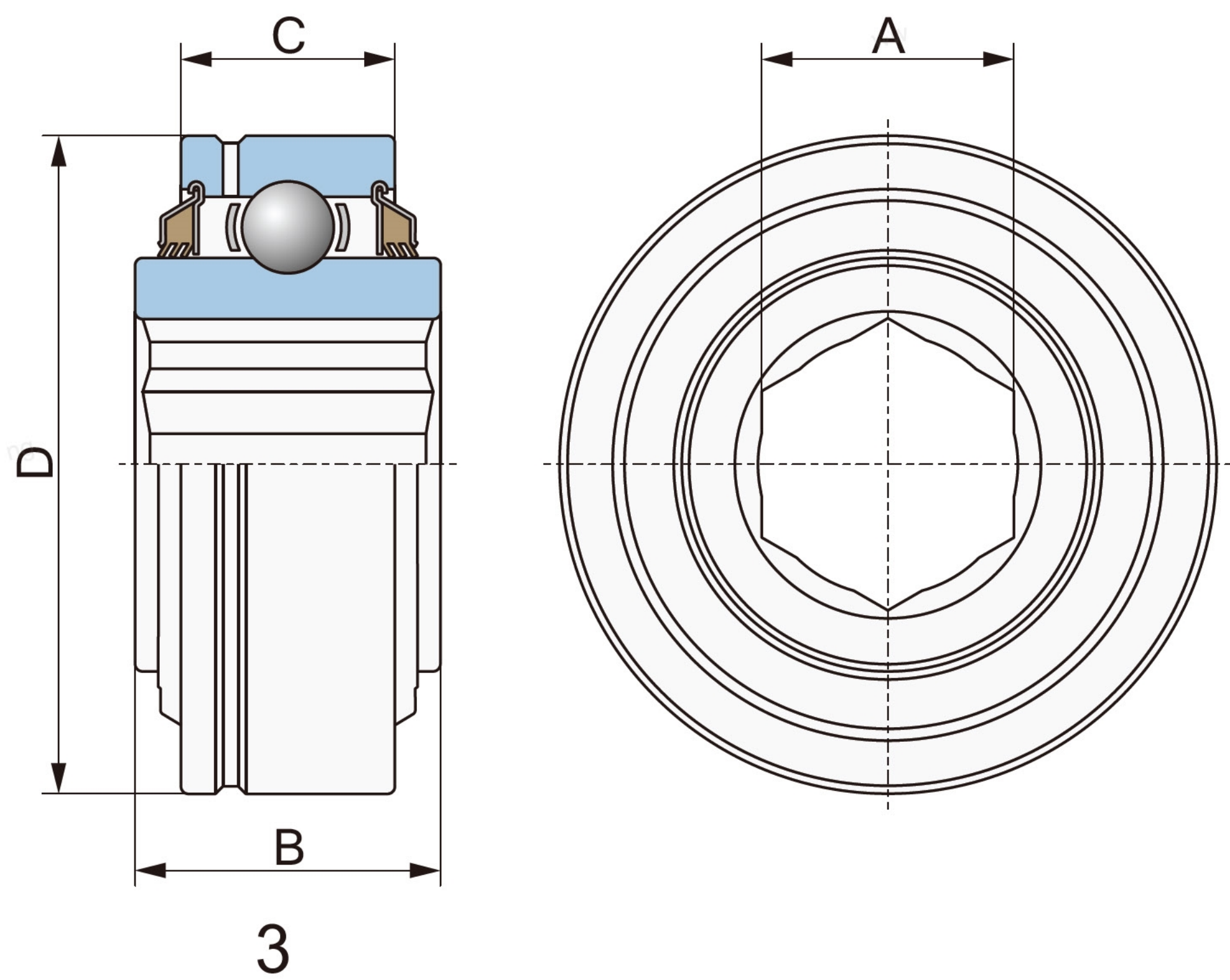

Non-Relubricate — Single lip seals

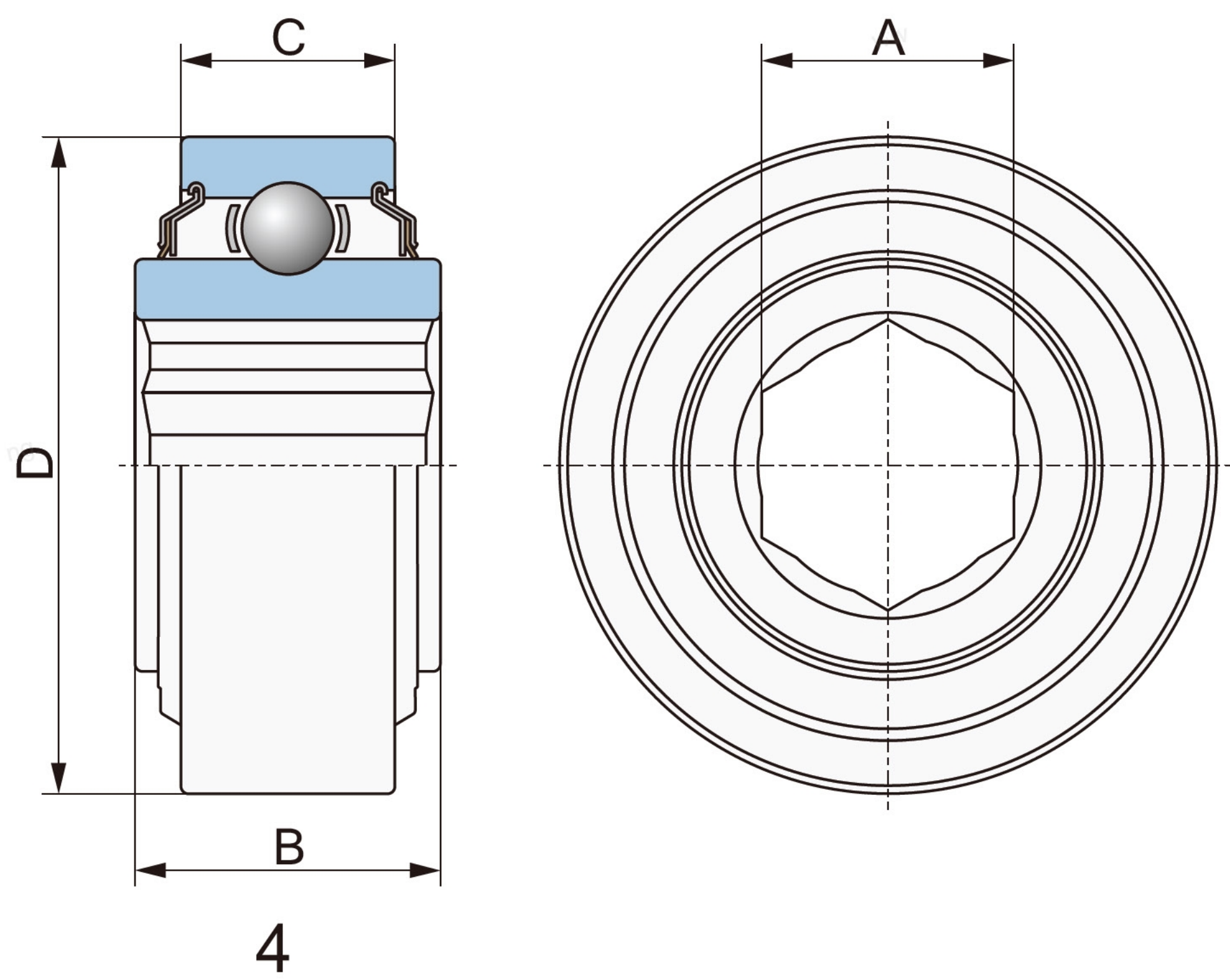



Unfixed Bearings — Cylindrical Outside Diameter — Hex Bore

Designation			d, mm		D, mm		B, mm		C, mm		Load Rating, N		Weight, kg
											Dynamic	Static	
202	KRR3	4	14,300	+0,127	35,000	-0,013	13,000	-0,127	11,000	-0,127	9.600	4.500	0,060
204	KPP2	1	17,653	+0,127	47,000	-0,013	20,955	-0,127	14,000	-0,127	12.900	6.300	0,160
204	KRR2	4	17,653	+0,127	47,000	-0,013	20,955	-0 127	14,000	-0,127	12.900	6.300	0,150
205	PP13	1	22,250	+0,127	52 000	-0,013	25,400	-0,127	15,000	-0,127	14.100	7.200	0,220
205	KRR2	4	22,250	+0,127	52,000	-0,013	25,400	-0,127	15 000	-0,127	14.100	7.200	0,200
206	KPP3	1	25,425	+0,127	62,000	-0,013	24,000	-0,127	16,000	-0,127	19.500	10.400	0,340
206	KPP4	1	25,425	+0,127	62,000	-0,013	24,000	-0,127	16,000	-0,127	19.500	10.400	0,340
G206	KPP4	3	25,425	+0,127	62,000	-0,013	24,000	-0 127	18,000	-0,127	19.500	10.400	0,360
206	KRR6	4	25,425	+0,127	62 000	-0,013	24,000	-0,127	16,000	-0,127	19.500	10.400	0,340
207	KRR12	4	28,600	+0,127	72,000	0,013	25,000	-0,127	17 000	-0,127	25.700	14 100	0,400
207	KRR9	4	28,600	+0,127	72,000	-0,013	37,694	-0,152	17,000	-0,127	25.700	14.100	0,460
207	KPP3	1	31,775	+0,127	72,000	-0,013	37,694	-0,152	17,000	-0,127	25.700	14.100	0,460
G207	KPP3	3	31,775	+0,127	72,000	-0,013	37,694	-0 152	17,000	-0,127	25.700	14.100	0,460
207	KRR17	4	31,775	+0,127	72 000	-0,013	37,694	-0,152	17,000	-0,127	25.700	14.100	0,460
W208	PP21	1	31,775	+0,127	80,000	0,013	36,525	-0,152	18 000	-0,127	30.000	15 000	0,660
W208	KRR8	4	31,775	+0,127	80,000	-0,013	36,525	-0,152	18,000	-0,127	30.000	15.000	0,660
209	KRR2	4	38,125	+0,127	85,000	-0,015	30,175	-0,127	19,000	-0,127	30.100	17.000	0,580
W210	PP7	2	41,300	+0,127	90,000	-0,015	30,175	-0 127	30,175	-0,127	32.200	19.000	1,270



Unfixed Bearings — Spherical Outside Diameter — Hex Bore

Non-Relubricate — Triple  
lip seals

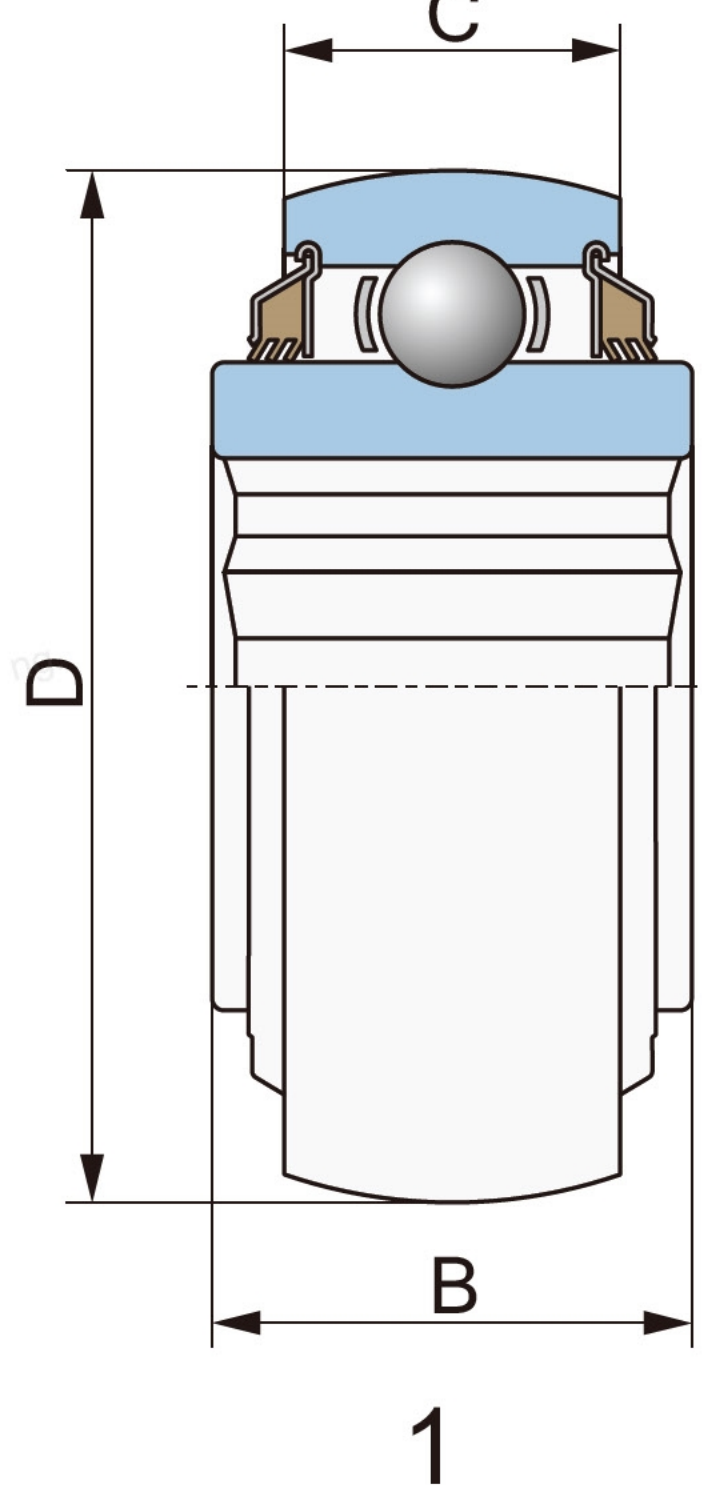

Relubricate — Triple lip seals

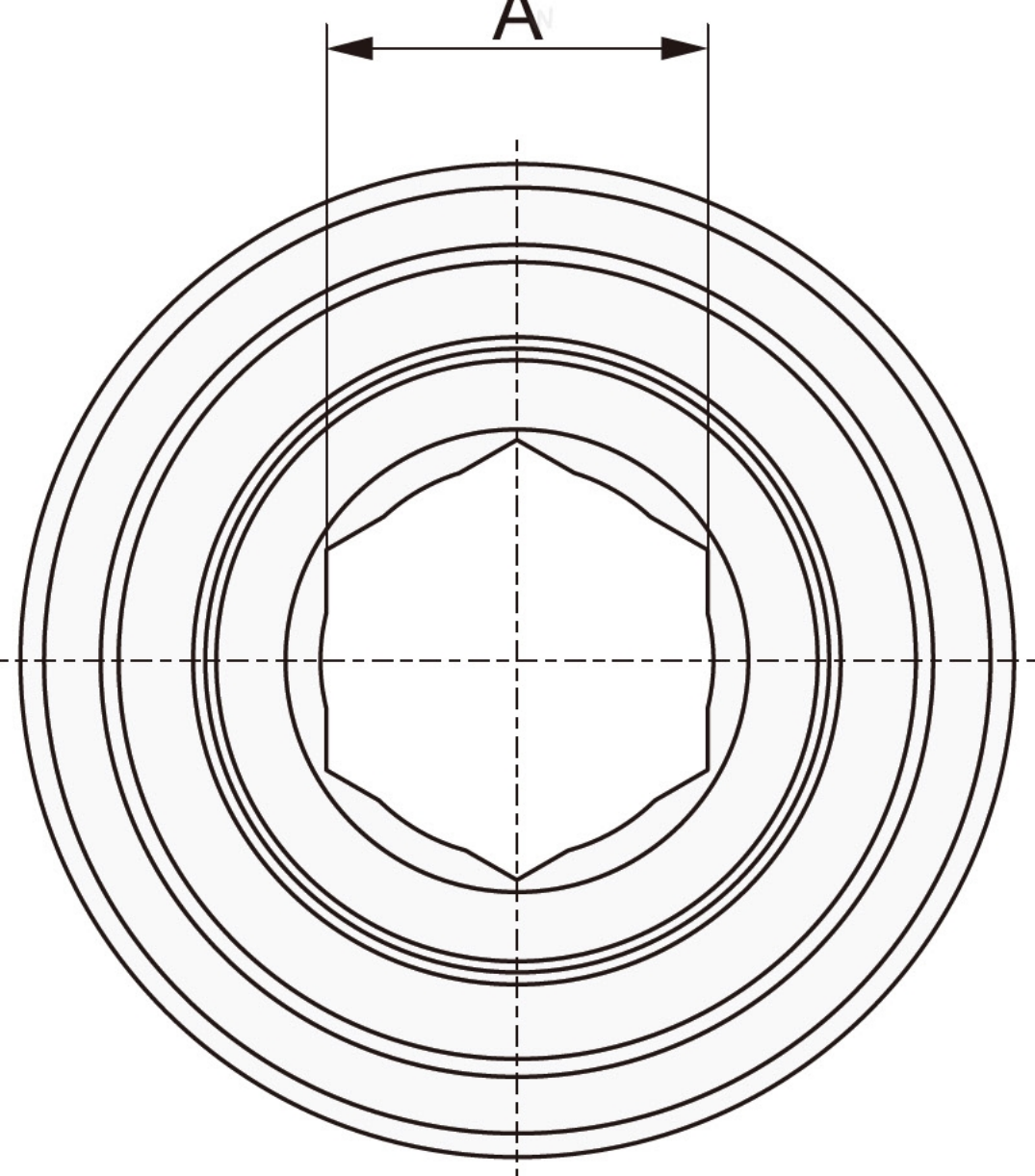
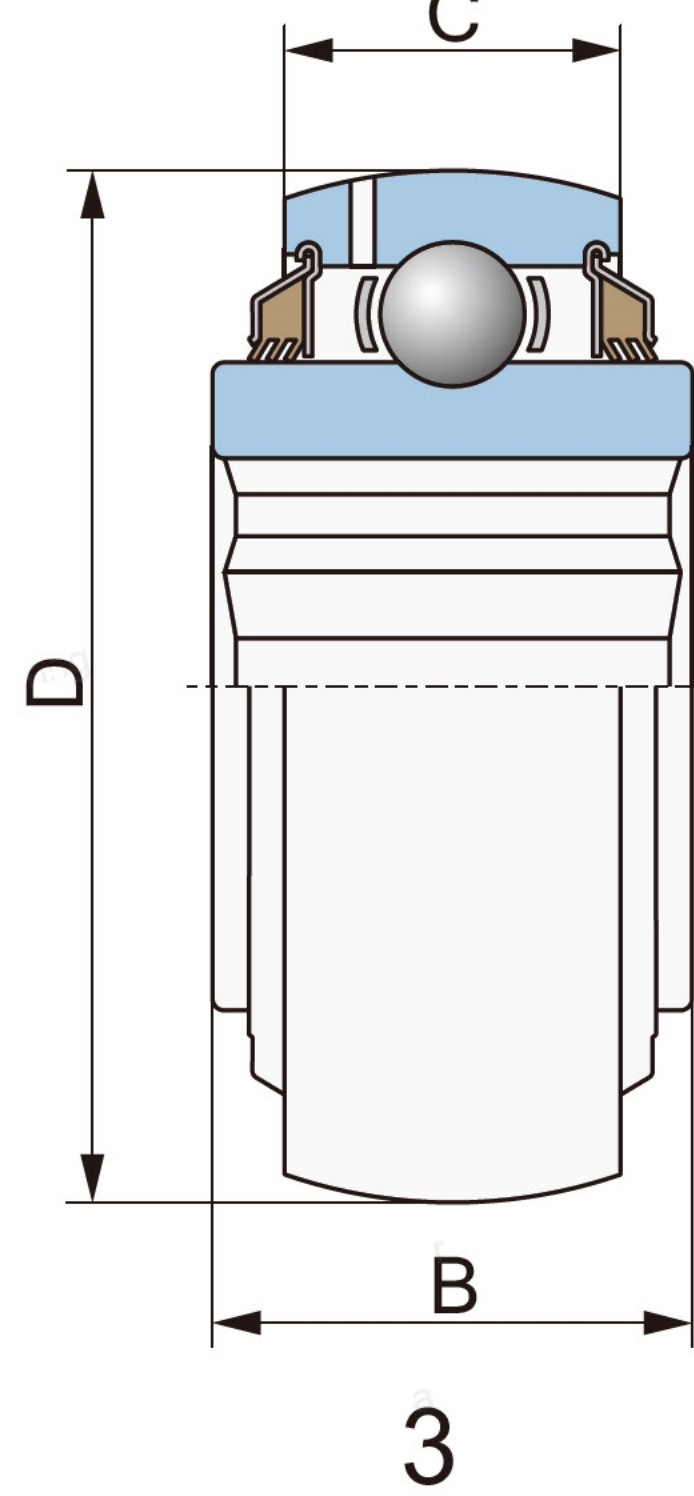

Non-Relubricate — Triple lip seals

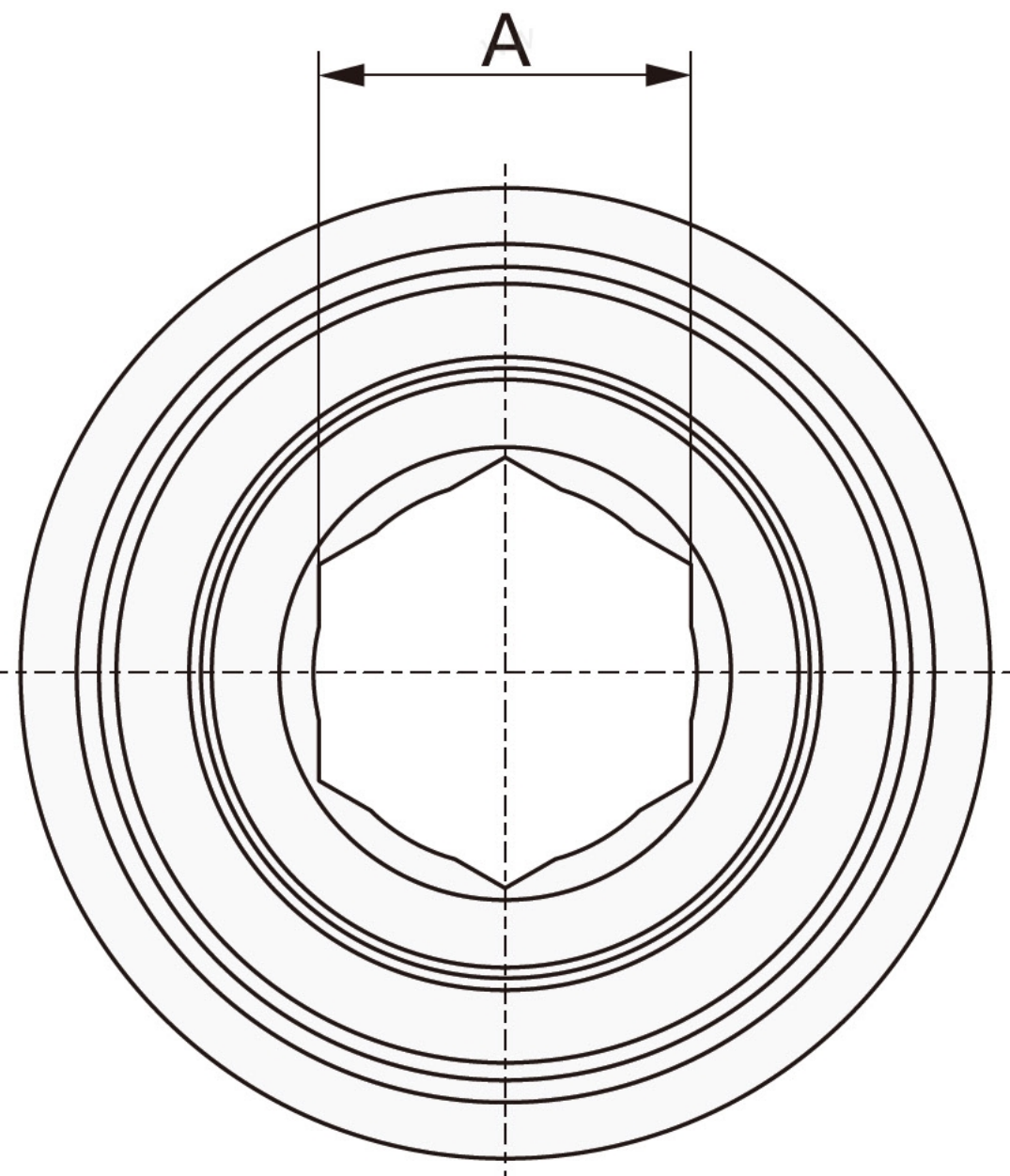
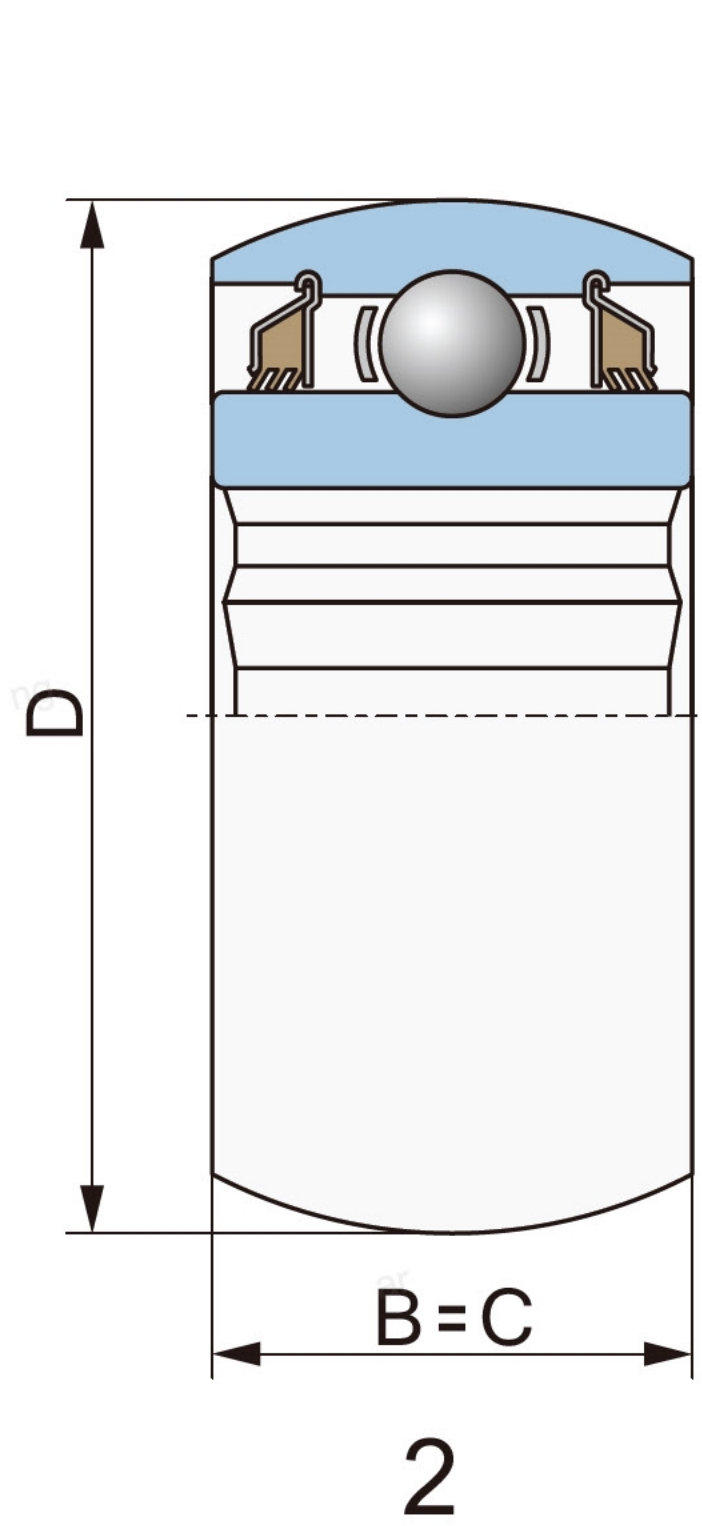

Non-Relubricate — Single  
lip seals

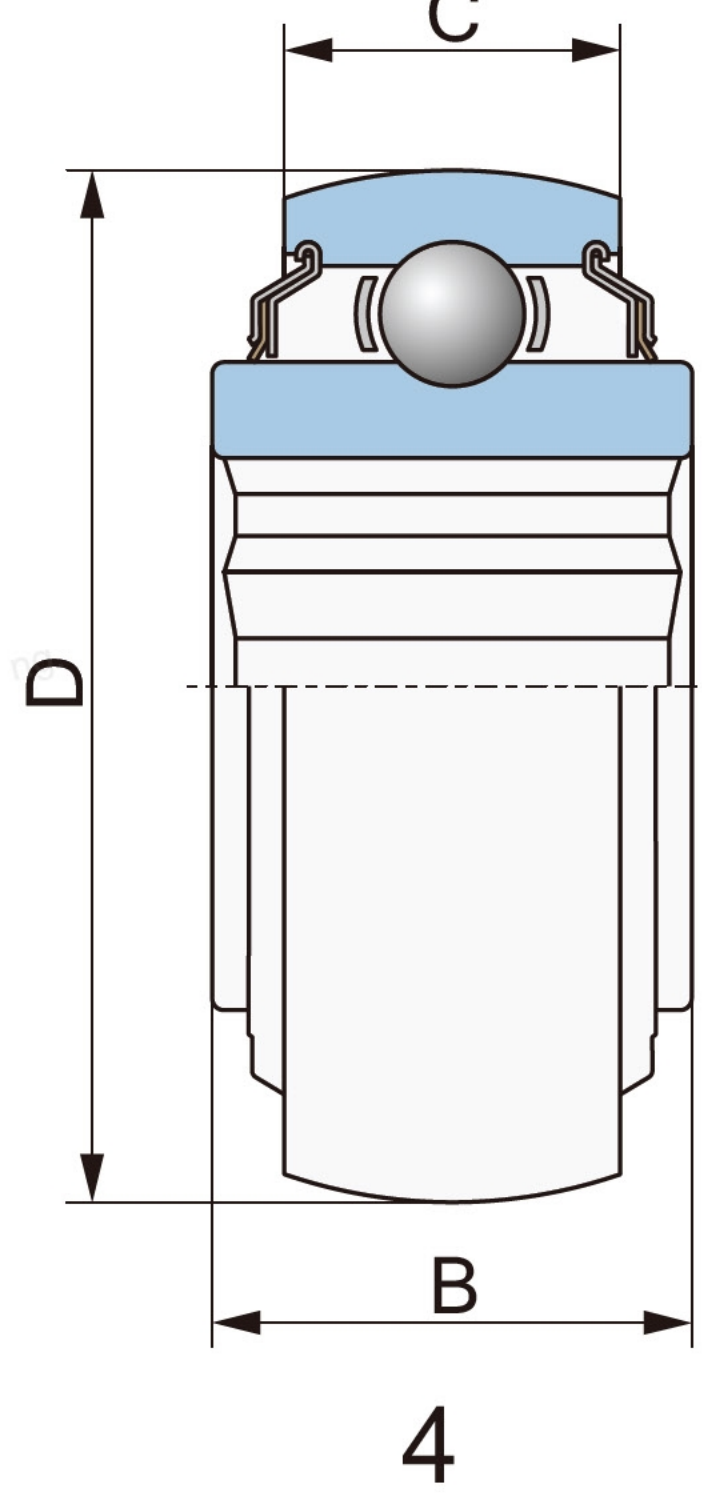

Relubricate — Single lip seals

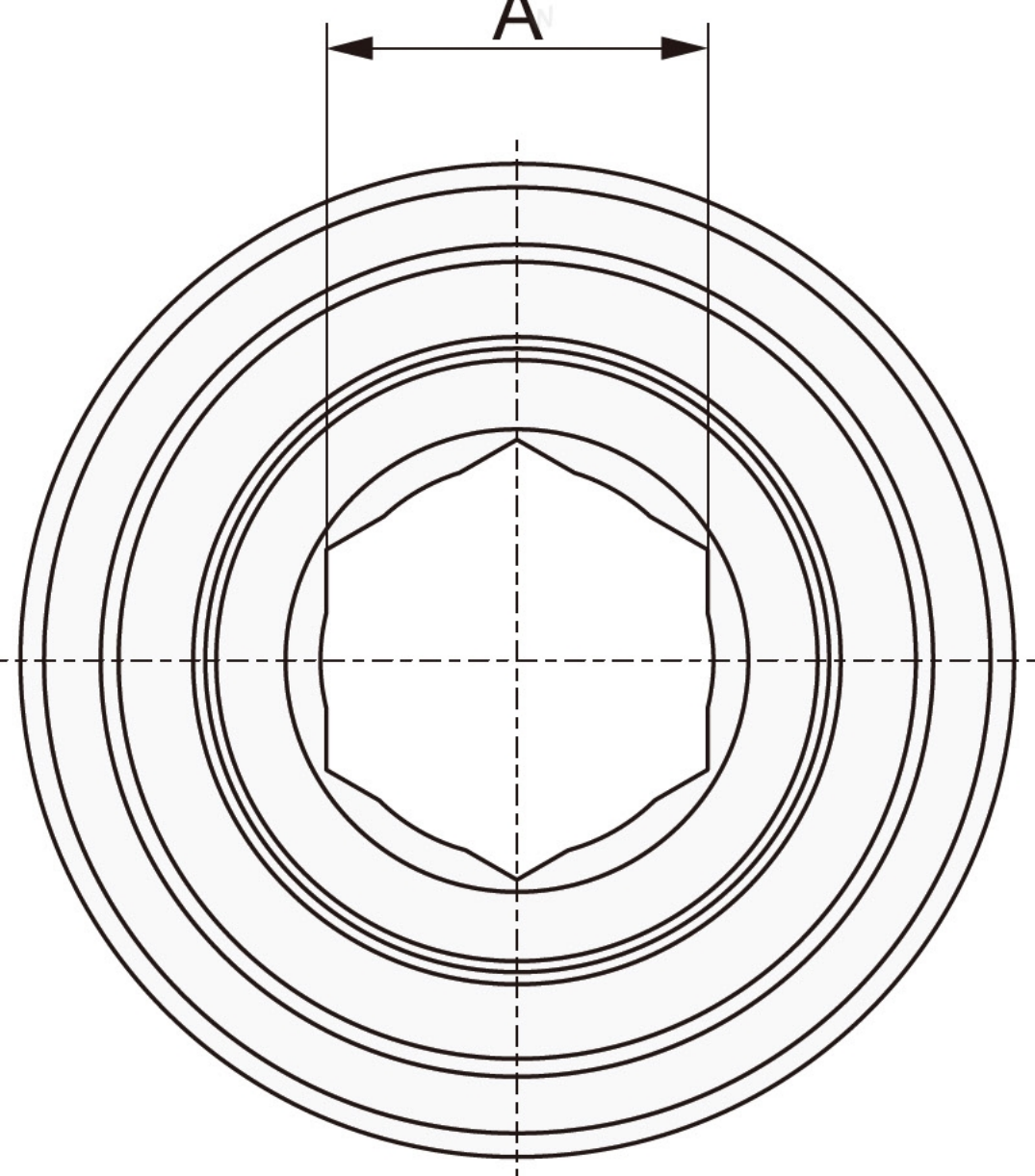
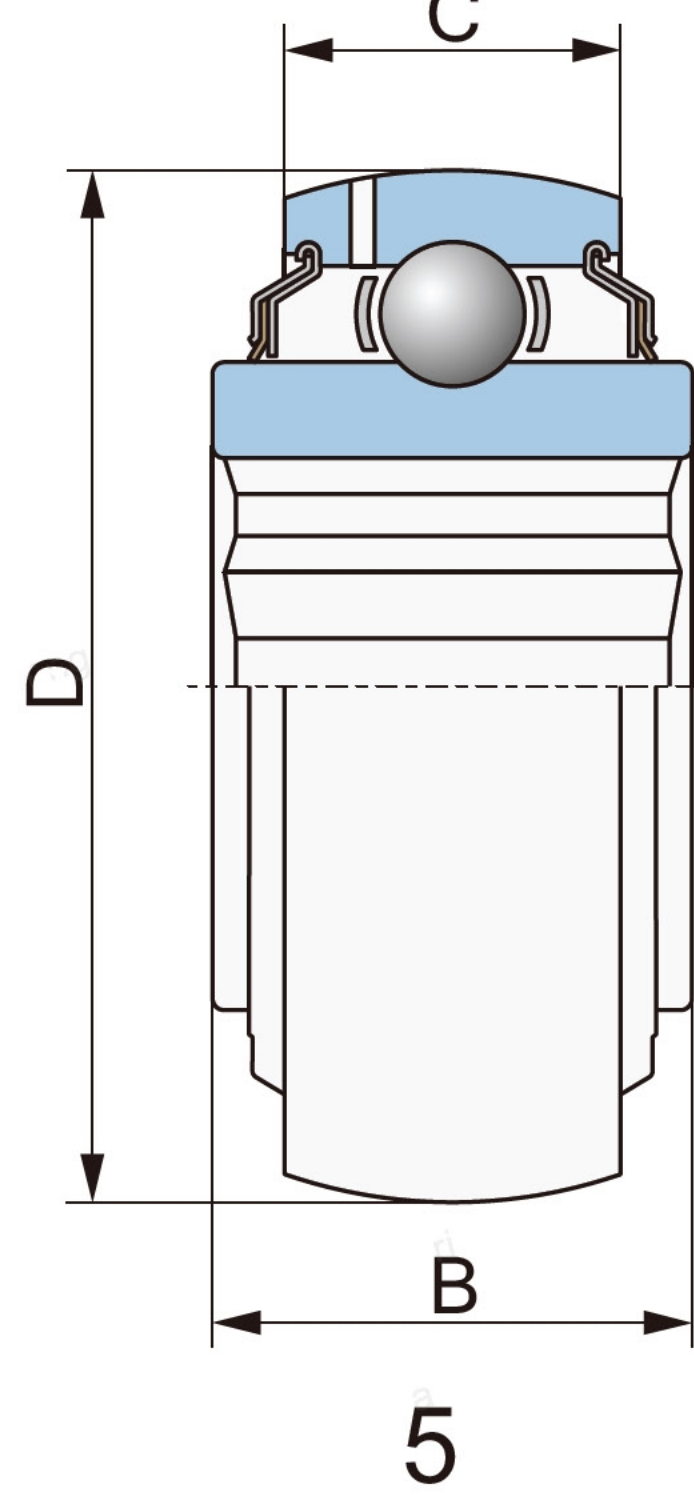



Unfixed Bearings — Spherical Outside Diameter — Hex Bore

Designation			d, mm		D, mm		B, mm		C, mm		Load Rating, N		Weight, kg
											Dynamic	Static	
204	KRRB2	4	17,653	+0,127	47,000	-0,013	20,955	-0,127	14,000	-0,127	12.900	6.300	0,150
205	PPB13	1	22,250	+0,127	52,000	-0,013	25,400	-0,127	15,000	-0,127	14.100	7.200	0,220
205	KRRB2	4	22,250	+0,127	52,000	-0,013	25,400	-0 127	15,000	-0,127	19.500	10.400	0,200
206	KPPB3	1	25,425	+0,127	62 000	-0,013	24,000	-0,127	16,000	-0,127	19.500	10.400	0,340
206	KPPB5	1	25,425	+0,127	62,000	-0,013	26,924	-0,127	16 000	-0,127	19.500	10 400	0,370
G206	KPPB4	3	25,425	+0,127	62,000	-0,013	24,000	-0,127	18,000	-0,127	19.500	10.400	0,350
206	KRRB6	4	25,425	+0,127	62,000	-0,013	24,000	-0,127	16,000	-0,127	19.500	10.400	0,340
G206	KRRB6	5	25,425	+0,127	62,000	-0,013	24,000	-0 127	16,000	-0,127	19.500	10.400	0,340
G207	KPPB2	3	28,600	+0,127	72 000	-0,013	37,694	-0,152	19,000	-0,127	25.700	14.100	0,500
207	KRRB9	4	28,600	+0,127	72,000	0,013	37,694	-0,152	17 000	-0,127	25.700	14 100	0,460
207	KRRB12	4	28,600	+0,127	72,000	-0,013	25,000	-0,127	17,000	-0,127	25.700	14.100	0,400
207	KPPB3	1	31,775	+0,127	72,000	-0,013	25,000	-0,127	17,000	-0,127	25.700	14.100	0,370
207	PPB5	1	31,775	+0,127	72,000	-0,013	31,770	-0 127	17,000	-0,127	25.700	14.100	0,450
207	KRRB17	4	31,775	+0,127	72 000	-0,013	37,694	-0,152	17,000	-0,127	25.700	14.100	0,500
W208	PPB16	1	31,775	+0,127	80,000	0,013	36,525	-0,152	18 000	-0,127	30.000	15 000	0,660
GW208	KRRB5	5	31,775	+0,127	80,000	-0,013	36,525	-0,152	21,000	-0,127	30.000	15.000	0,640
GW208	PPB22	3	31,877	+0,127	80,000	-0,013	36,525	-0,152	21,000	-0,127	30.000	15.000	0,680
W208	KRRB6	4	34,950	+0,127	80,000	-0,013	36,525	-0 152	21,000	-0,127	30.000	15.000	0,600
G209	KPPB2	3	38,125	+0,127	85 000	-0,015	30,175	-0,127	19,000	-0 127	30.100	17.000	0,580
209	KRRB2	4	38,125	+0,127	85,000	-0,015	30,175	-0,127	19 000	-0,127	30.100	17 000	0,580
G210	KPPB2	3	38,125	+0,127	90,000	-0,015	30,175	-0,127	22,000	-0,127	32.200	19.000	1,110
210	RRB6	4	38,125	+0,127	90,000	-0,015	30,175	-0,127	22,000	-0,127	32.200	19.000	1,110
W210	PPB7	2	41,300	+0,127	90,000	-0,015	30,175	-0 127	30,175	-0,127	32.200	19.000	1,270