

Plummer Housings

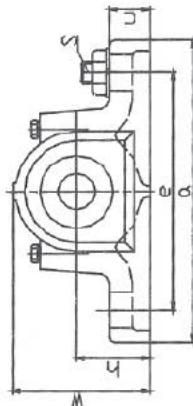
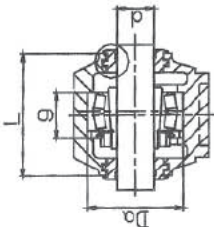
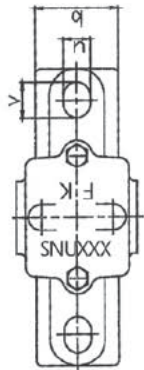
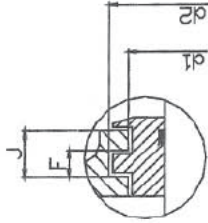

Housing NO.	Dimensions (mm / in.)																Bearing No.	Adapter Sleeve	Locating Ring		wt (kg)
	d	Da	g	a	b	c	h	W	L	e	u	v	s	d1	d2	J			F	Number	
SNU505	20	52	25	165	46	19	40	73	67	130	13	20	M10	31.5	39.5	7.5	5	H205	SR52x5	2	1.90
SNU506-605	25	62	32	185	52	22	50	88	77	150	13	22	M10	36.5	44.5	7.5	5	H206	SR62x5	2	2.20
SNU507-606	30	72	34	185	52	22	50	93	82	150	13	20	M10	46.5	54.5	7.5	5	H207	SR72x8.5	2	2.40
SNU508-607	35	80	39	205	60	25	60	108	85	170	15	20	M12	51.5	59.5	7.5	5	H208	SR80x10.5	2	3.20
SNU509	40	85	30	205	60	25	60	111	85	170	15	20	M12	56.5	64.5	8.5	5	H209	SR85x5.5	2	3.50
SNU510-608	45	90	41	205	60	25	60	114	90	170	15	20	M12	62.0	70.5	8.5	5	H210	SR90x10.5	2	3.85
SNU511-609	50	100	44	255	70	28	70	129	95	210	18	23	M16	67.0	75.5	8.5	5	H211	SR100x11.5	2	5.20
SNU512-610	55	110	48	255	70	30	70	134	105	210	18	23	M16	72.0	80.5	8.5	5	H212	SR110x13	2	6.70
SNU513-611	60	120	51	275	80	30	80	149	110	230	18	24	M16	77.0	85.5	8.5	5	H213	SR120x10	2	7.90
SNU515-612	65	130	56	280	80	30	80	155	115	230	18	26	M16	87.0	95.5	8.5	5	H215	SR130x15.5	2	7.70
SNU516-613	70	140	58	315	90	32	95	175	120	260	22	29	M20	92.5	101.0	10.5	5	H216	SR140x16	2	11.0
SNU517	75	150	61	320	90	32	95	181	125	260	22	30	M20	97.5	106.0	10.5	5	H217	SR150x16.5	2	12.7
SNU518-615	80	160	65	345	100	35	100	192	140	290	22	27	M20	102.5	111.0	10.5	5	H218	SR160x17.5	2	14.8
SNU519-616	85	170	68	345	100	35	112	209	145	290	22	27	M20	131.0	141.0	11.5	6	H219	SR170x18	2	15.5
SNU520-617	90	180	70	380	110	40	112	215	160	320	26	32	M24	137.5	147.5	11.5	6	H220	SR180x18	2	18.4
SNU522-619	95	200	80	410	120	45	125	239	175	350	26	32	M24	147.5	157.5	11.5	6	H222	SR200x21	2	24.8
SNU524-620	100	215	86	410	120	45	140	271	185	350	26	32	M24	157.5	167.5	11.5	6	H3124	SR215x14	2	32.2
SNU526	110	230	90	445	130	50	150	290	190	380	28	35	M24	167.5	177.5	13.0	6	H3126	SR230x13	1	39.8
SNU528	115	250	98	500	150	50	150	302	205	420	35	42	M30	177.5	187.5	13.0	6	H3128	SR250x15	2	48.8
SNU530	135	270	106	530	160	60	160	323	220	450	35	42	M30	192.5	202.5	13.5	6	H3130	SR270x16.5	2	56.5
SNU532	140	290	114	550	160	60	170	344	235	470	35	42	M30	202.5	212.5	13.5	6	H3132	SR290x17	2	63.5

NOTES: 1. Foot of standard housing SSN type is solid without mounting holes or can be precast as 2-bolt (with prefix T) or 4-bolt mounting holes (with prefix F). 2. Taconite seal will be supplied as optional for perfect arrangement in severe operating conditions to prevent contamination from fine abrasive dust. 3. ZF rubber seals can be supplied upon request.