

Flange Cartridge Units
(with adapter mounted)

UKFC2 (Normal-duty)

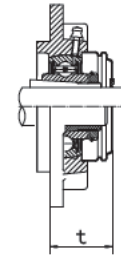
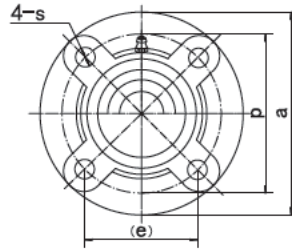
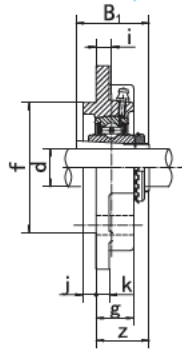

UKFC-C1(D1)

Unit NO.	Dimensions (mm / in.)													Bolt Size mm/in.	Bearing No.	Housing No.	Weight (kg)
	d	a	p	(e)	i	s	j	k	g	f	z	t	B ₁				
UKFC205;H2305 205;HE2305	20 3/4	115 4-17/32	90 3-35/64	63.6 2-1/2	10 15/64	12 25/32	6 15/64	7 9/32	21 53/64	70 2.7559	29.5 1-5/32	34 1-11/32	35 1.378	M10 3/8	UK205;H2305 UK205;HE2305	FC205	0.93
UKFC206;H2306 206;HS2306 206;HE2306	25 7/8 1	125 4-59/64	100 3-15/16	70.7 2-25/32	10 25/64	12 15/32	8 5/16	8 5/16	23 29/32	80 3.1496	31 1-7/32	36.5 1-7/16	38 1.496	M10 3/8	UK206;H2306 UK206;HS2306 UK206;HE2306	FC206	1.24
UKFC207;H2307 207;HS2307	30 1-1/8	135 5-5/16	110 4-21/64	77.8 3-11/16	11 7/16	14 35/64	8 5/16	9 23/64	26 1-1/32	90 3.5433	33.5 1-5/16	41 1-5/8	43 1.693	M12 7/16	UK207;H2307 UK207;HS2307	FC207	1.60
UKFC208;H2308 208;HE2308 208;HS2308	35 1-1/4 1-3/8	145 5-45/64	120 4-23/32	84.8 3-11/32	11 7/16	14 35/64	10 25/64	9 23/64	26 1-1/32	100 3.9370	35.5 1-25/64	45.5 1-51/64	46 1.811	M12 7/16	UK208;H2308 UK208;HE2308 UK208;HS2308	FC208	1.92
UKFC209;H2309 209;HA2309 209;HE2309 209;HS2309	40 1-7/16 1-1/2 1-5/8	160 6-19/64	132 5-13/64	93.3 3-43/64	10 25/64	16 5/8	12 15/32	14 35/64	26 1-1/32	105 4.1339	36 1-27/64	44.5 1-3/4	50 1.969	M14 1/2	UK209;H2309 UK209;HA2309 UK209;HE2309 UK209;HS2309	FC209	2.65
UKFC210;H2310 210;HS2310 210;HA2310 210;HE2310	45 1-5/8 1-11/16 1-3/4	165 6-1/2	138 5-7/16	97.6 3-27/32	10 25/64	16 5/8	12 15/32	14 35/64	28 1-7/64	110 4.3307	37.5 1-15/32	47.5 1-7/8	55 2.165	M14 1/2	UK210;H2310 UK210;HS2310 UK210;HA2310 UK210;HE2310	FC210	2.96
UKFC211;H2311 211;HS2311 211;HA2311 211;HE2311	50 1-7/8 1-15/16 2	185 7-9/32	150 5-29/32	106.1 4-3/16	13 33/64	19 3/4	12 15/32	15 19/32	31 1-7/32	125 4.9213	41.5 1-41/64	51 2-1/64	59 2.323	M16 5/8	UK211;H2311 UK211;HS2311 UK211;HA2311 UK211;HE2311	FC211	4.02
UKFC212;H2312 212;HS2312	55 2-1/8	195 7-11/16	160 6-19/64	113.1 4-29/64	17 43/64	19 3/4	12 15/32	15 19/32	36 1-27/64	135 5.3150	48 1-57/64	61.5 2-27/64	62 2.441	M16 5/8	UK212;H2312 UK212;HS2312	FC212	4.77
UKFC213;H2313 213;HA2313 213;HE2313 213;HS2313	60 2-3/16 2-1/4 2-3/8	205 8-5/64	170 6-11/16	120.2 4-47/64	16 5/8	19 3/4	14 35/64	15 19/32	36 1-27/64	145 5.5118	49 1-15/16	60.5 2-25/64	65 2.559	M16 5/8	UK213;H2313 UK213;HA2313 UK213;HE2313 UK213;HS2313	FC213	5.41
UKFC215;H2315 215;HA2315 215;HE2315	65 2-7/16 2-1/2	220 8-21/32	184 7-1/4	130.1 5-1/8	18 23/32	19 3/4	16 5/8	18 23/32	40 1-37/64	160 6.2992	53.5 2-7/64	67.5 2-21/32	73 2.874	M16 5/8	UK215;H2315 UK215;HA2315 UK215;HE2315	FC215	7.25
UKFC216;H2316 216;HA2316 216;HE2316	70 2-11/16 2-3/4	240 9-29/64	200 7-7/8	141.4 5-9/16	18 23/32	23 29/32	16 5/8	18 23/32	42 1-21/32	170 6.6929	57 2-1/4	72.5 2-55/64	78 3.071	M20 3/4	UK216;H2316 UK216;HA2316 UK216;HE2316	FC216	8.90
UKFC217;H2317 217;HA2317 217;HE2317	75 2-15/16 3	250 9-27/32	208 8-3/16	147.1 5-51/64	18 23/32	23 29/32	18 23/32	20 25/32	45 1-25/32	180 7.0866	59 2-21/64	74.6 2-15/16	82 3.228	M20 3/4	UK217;H2317 UK217;HA2317 UK217;HE2317	FC217	10.60
UKFC218;H2318 218;HA2318	80 3-3/16	265 10-7/16	220.0 8-21/32	155.5 6-1/8	22 55/64	23 29/32	18 23/32	20 25/32	50 1-31/32	190 7.4803	64.5 3-35/64	83.5 3-9/32	86 3.386	M20 3/4	UK218;H2318 UK218;HA2318	FC218	12.54