

UKF3 (Heavy-duty)

Flange Units (Square)
(with adapter mounted)

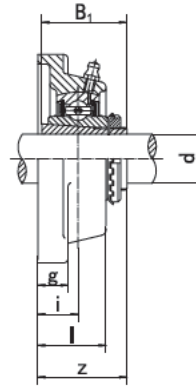
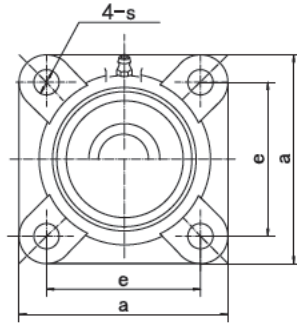

Unit NO.	Dimensions (mm / in.)										Bolt Size mm/in.	Bearing No.	Housing No.	Weight (kg)
	d	a	e	i	g	l	s	z	B ₁					
UKF305;H2305 305;HE2305	20 3/4	110 4-11/32	80 3-5/32	16 5/8	13 1/2	29 1-5/32	16 5/8	37.0 1-29/64	35.0 1.378	M14 1/2	UK305;H2305 UK305;HE2305	F305	1.10	
UKF306;H2306 306;HS2306 306;HE2306	25 7/8 1	125 4-29/32	95 3-47/64	18 45/64	15 19/32	32 1-1/4	16 5/8	40.5 2-19/32	38.0 1.496	M14 1/2	UK306;H2306 UK306;HS2306 UK306;HE2306	F306	1.60	
UKF307;H2307 307;HS2307	30 1-1/8	135 5-5/16	100 3-15/16	20 25/32	16 5/8	36 1-13/32	19 3/4	44.5 2-3/4	43.0 1.693	M16 5/8	UK307;H2307 UK307;HS2307	F307	2.00	
UKF308;H2308 308;HE2308 308;HS2308	35 1-1/4 1-3/8	150 5-29/32	112 4-13/32	23 29/32	17 21/32	40 1-9/16	19 3/4	50.0 2-31/32	46.0 1.811	M16 5/8	UK308;H2308 UK308;HE2308 UK308;HS2308	F308	2.70	
UKF309;H2309 309;HA2309 309;HE2309 309;HS2309	40 1-7/16 1-1/2 1-5/8	160 6-6/16	125 4-59/64	25 63/64	18 23/32	44 1-23/32	19 3/4	54.5 2-9/64	50.0 1.969	M16 5/8	UK309;H2309 UK309;HA2309 UK309;HE2309 UK309;HS2309	F309	3.40	
UKF310;H2310 310;HS2310 310;HA2310 310;HE2309	45 1-5/8 1-11/16 1-3/4	175 6-7/8	132 5-13/64	28 1-7/64	19 3/4	48 1-7/8	23 29/32	60.0 2-23/64	55.0 2.165	M20 3/4	UK310;H2310 UK310;HS2310 UK310;HA2310 UK310;HE2309	F310	4.60	
UKF311;H2311 311;HS2311 311;HA2311 311;HE2311	50 1-7/8 1-15/16 2	185 7-9/32	140 5-33/64	30 1-3/16	20 25/32	52 2-1/16	23 29/32	63.5 2-1/2	59.0 2.323	M20 3/4	UK311;H2311 UK311;HS2311 UK311;HA2311 UK311;HE2311	F311	5.50	
UKF312;H2312 312;HS2312	55 2-1/8	195 7-11/16	150 5-29/32	33 1-19/64	22 7/8	56 2-7/32	23 29/32	69.0 2-23/32	62.0 2.441	M20 5/8	UK312;H2312 UK312;HS2312	F312	6.80	
UKF313;H2313 313;HA2313 313;HE2313 313;HS2313	60 2-3/16 2-1/4 2-3/8	208 8-3/16	166 6-17/32	33 1-19/64	22 7/8	58 2-9/32	23 29/32	71.0 2-51/64	65.0 2.559	M20 3/4	UK313;H2313 UK313;HA2313 UK313;HE2313 UK313;HS2313	F313	7.80	
UKF315;H2315 315;HA2315 315;HE2315	65 2-7/16 2-1/2	236 9-9/32	184 7-1/4	39 1-17/32	25 63/64	66 2-19/32	25 63/64	81.0 3-3/16	73.0 2.874	M22 7/8	UK315;H2315 UK315;HA2315 UK315;HE2315	F315	11.20	
UKF316;H2316 316;HA2316 316;HE2316	70 2-11/16 2-3/4	250 9-27/32	196 7-23/32	38 1-1/2	27 1-1/16	68 2-11/16	31 1-7/32	83.5 3-9/32	78.0 3.071	M27 1	UK316;H2316 UK316;HA2316 UK316;HE2316	F316	13.50	
UKF317;H2317 317;HA2317 317;HE2317	75 2-15/16 3	260 10-1/4	204 8-1/32	44 1-47/64	27 1-1/16	74 2-29/32	31 1-7/32	92.0 3-5/8	82.0 3.228	M27 1	UK317;H2317 UK317;HA2317 UK317;HE2317	F317	15.60	
UKF318;H2318 318;HA2318	80 3-3/16	280 11-1/32	216 8-1/2	44 1-47/64	30 1-3/16	76 3	35 1-3/8	93.5 3-11/16	86.0 3.386	M30 1-1/8	UK318;H2318 UK318;HA2318	F318	18.90	
UKF319;H2319 319;HA2319	85 3-5/16	290 11-13/32	228 8-31/32	59 2-21/64	30 1-3/16	94 3-11/16	35 1-3/8	111 4-3/8	90.0 3.543	M30 1-1/8	UK319;H2319 UK319;HA2319	F319	23.20	
UKF320;H2320 320;HA2320	90 3-7/16	310 12-7/32	242 9-17/32	59 2-21/64	32 1-1/4	94 3-11/16	38 1-1/2	115.0 4-17/32	97.0 3.814	M33 1-1/4	UK320;H2320 UK320;HA2320	F320	26.30	
UKF322;H2322 322;HA2322	100 3-15/16	340 13-3/8	266 10-15/32	60 3-23/64	35 1-3/8	96 3-25/32	41 1-39/64	121.0 4-49/64	105.0 4.134	M36 1-3/8	UKF322;H2322 UKF322;HA2322	F322	35.30	
UKF324;H2324 324;HA2324	110 4-3/16	370 14-9/16	290 11-27/64	65 2-9/16	40 1-9/16	110 4-11/32	41 1-39/64	130.0 5-1/8	112.0 4.41	M36 1-3/8	UK324;H2324 UK324;HA2324	F324	47.70	
UKF326;H2326 326;HA2326	115 4-7/16	410 16-5/32	320 12-19/32	65 2-9/16	45 1-25/32	115 4-17/32	41 1-39/64	134.0 5-9/32	121.0 4.764	M36 1-3/8	UK326;H2326 UK326;HA2326	F326	63.10	
UKF328;H2328 328;HA2328	125 4-15/16	450 17-23/32	350 13-25/32	75 2-61/64	55 2-5/32	125 4-29/32	41 1-39/64	148.0 5-53/64	131.0 5.158	M36 1-3/8	UK328;H2328 UK328;HA2328	F328	87.00	