

UCFCX (Medium-duty)

Flange Cartridge Units

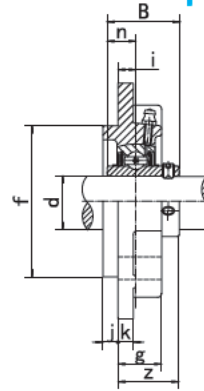
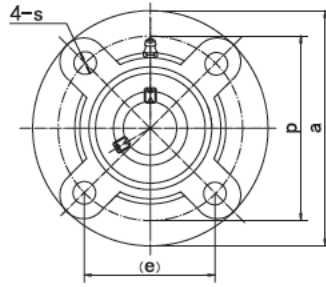

Unit NO.	Dimensions (mm / in.)													Bolt Size mm/in.	Bearing No.	Housing No.	Weight (kg)
	d	a	p	(e)	i	s	j	k	g	f	z	B	n				
UCFCX05 X05-13 X05-14 X05-15 X05-16	25 13/16 7/8 15/16 1	111 4-3/8	92 3-5/8	65 2-9/16	10 25/64	9.5 3/8	6 15/64	9.5 3/8	24 15/16	76 2.9921	32.2 1-9/32	38.1 1.5000	15.9 0.626	M8 5/16	UCX05 UCX05-13 UCX05-14 UCX05-15 UCX05-16	FCX05	1.10
UCFCX06 X06-17 X06-18 X06-19 X06-20	30 1-1/16 1-1/8 1-3/16 1-1/4	127 5	105 4-9/64	74.2 2-59/64	8 5/16	12 15/32	9.5 3/8	9.5 3/8	22.5 7/8	85 3.3465	33.4 1-5/16	42.9 1.6890	17.5 0.689	M10 3/8	UCX06 UCX06-17 UCX06-18 UCX06-19 UCX06-20	FCX06	1.40
UCFCX07 X07-21 X07-22 X07-23	35 1-5/16 1/3/8 1-7/16	133 5-1/4	111 4-3/8	78.5 3-3/32	9 23/64	12 15/32	11 7/16	11 7/16	26 1-1/32	92 3.6220	39.2 1-17/32	49.2 1.9370	19 0.748	M10 3/8	UCX07 UCX07-21 UCX07-22 UCX07-23	FCX07	1.80
UCFCX08 X08-24 X08-25	40 1-1/2 1-9/16	133 5-1/4	111 4-3/8	78.5 3-3/32	9 23/64	12 15/32	11 7/16	11 7/16	26 1-1/32	92 3.6220	39.2 1-17/32	49.2 1.9370	19 0.748	M14 3/8	UCX08 UCX08-24 UCX08-25	FCX08	1.80
UCFCX09 X09-26 X09-27 X09-28 X09-29	45 1-5/8 1-11/16 1-3/4 1-13/16	155 6-3/32	130 5-1/8	91.9 3-5/8	8 5/16	14 35/64	12 15/32	11 7/16	25 63/64	108 4.2520	40.6 1-19/32	51.6 2.0315	19 0.748	M12 7/16	UCX09 UCX09-26 UCX09-27 UCX09-28 UCX09-29	FCX09	2.40
UCFCX10 X10-30 X10-31 X10-32	50 1-7/8 1-15/16 2	162 6-3/8	136 5-23/64	96.2 3-25/32	7 9/32	14 35/64	16 5/8	11 7/16	25 63/64	118 4.6457	40.4 1-19/32	55.6 2.1890	22.2 0.874	M12 7/16	UCX10 UCX10-30 UCX10-31 UCX10-32	FCX10	2.90
UCFCX11 X11-33 X11-34 X11-35 X11-36 X11-37	55 2-1/16 2-1/8 2-3/16 2-1/4 2-5/16	180 7-3/32	152 5-63/64	107.5 4-15/64	4 5/32	16 5/8	22 55/64	13 1/2	26 1-1/32	127 5.0000	43.7 1-23/32	65.1 2.5630	25.4 1	M14 1/2	UCX11 UCX11-33 UCX11-34 UCX11-35 UCX11-36 UCX11-37	FCX11	3.80
UCFCX12 X13-38 X13-39	60 2-3/8 2-7/16	194 7-5/8	165 6-1/2	116.7 4-19/32	11 7/16	16 5/8	20 25/32	14 9/16	33 1-5/16	140 5.5118	50.7 2	65.1 2.5630	25.4 1	M14 1/2	UCX12 UCX12-38 UCX12-39	FCX12	4.90
UCFCX13 X13-40 X13-41	65 2-1/2 2-9/16	194 7-5/8	165 6-1/2	116.7 4-19/32	11 7/16	16 5/8	20 25/32	14 9/16	33 1-5/16	140 5.5118	55.4 2-3/16	74.6 2.9370	30.2 1.189	M14 1/2	UCX13 UCX13-40 UCX13-41	FCX13	4.90
UCFC14 X14-42 X14-43 X14-44	70 2-5/8 2-11/16 2-3/4	222 8-3/4	190 7-31/64	134.3 5-9/32	14 35/64	19 3/4	20 25/32	14 9/16	36 1-13/32	164 6.4567	58.5 2-5/16	77.8 3.0630	33.3 1.311	M16 5/8	UCX14 UCX14-42 UCX14-43 UCX14-44	FCX14	6.60
UCFCX15 X15-45 X15-46 X15-47 X15-48	75 2-13/16 2-7/8 2-15/16 3	222 8-3/4	190 7-31/64	134.3 5-9/32	12 15/32	19 3/4	22 55/64	16 5/8	35 1-3/8	164 6.4567	61.3 2-13/32	82.6 3.2520	33.3 1.311	M16 5/8	UCX15 UCX15-45 UCX15-46 UCX15-47 UCX15-48	FCX15	7.20
UCFCX16 X16-49 X16-50 X16-51 X16-52	80 3-1/16 3-1/8 3-3/16 3-1/4	260 10-1/4	219 8-5/8	154.8 6-3/32	10 25/64	23 29/32	25 63/64	19 3/4	36 1-13/32	186 7.3228	61.6 2-7/16	85.7 3.3740	34.1 1.343	M20 3/4	UCX16 UCX16-49 UCX16-50 UCX16-51 UCX16-52	FCX16	10.00
UCFCX17 X17-53 X17-55	85 3-5/16 3-7/16	260 10-1/4	219 8-5/8	154.8 6-3/32	10 25/64	23 29/32	25 63/64	19 3/4	36 1-13/32	186 7.3228	66.3 2-5/8	96 3.7795	39.7 1.563	M20 3/4	UCX17 UCX17-53 UCX17-55	FCX17	11.40