

Flange Units (Square)

UCF3 (Heavy-duty)

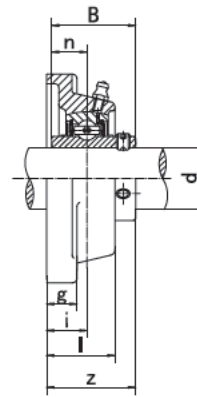
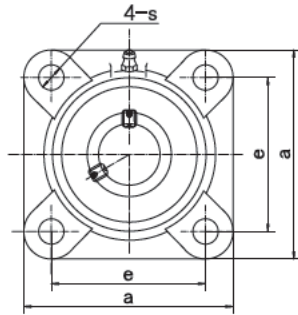

Unit NO.	Dimensions (mm / in.)										Bolt Size mm/in.	Bearing No.	Housing No.	Weight (kg)
	d	a	e	i	g	l	s	z	B	n				
UCF305 305-13 305-14 305-15 305-16	25 13/16 7/8 15/16 1	110	80	16	13	29	16	39	38	15	M14	UC305 UC305-13 UC305-14 UC305-15 UC305-16	F305	1.10
UCF306 306-17 306-18 306-19	30 1-1/16 1-1/8 1-3/16	125	95	18	15	32	16	44	43	17	M14	UC306 UC306-17 UC306-18 UC306-19	F306	1.50
UCF307 307-20 307-21 307-22 307-23	35 1-1/4 1-5/16 1-3/8 1-7/16	135	100	20	16	36	19	49	48	19	M16	UC307 UC307-20 UC307-21 UC307-22 UC307-23	F307	2.00
UCF308 308-24 308-25	40 1-1/2 1-9/16	150	112	23	17	40	19	56	52	19	M16	UC308 UC308-24 UC308-25	F308	2.60
UCF309 309-26 309-27 309-28	45 1-5/8 1-11/16 1-3/4	160	125	25	18	44	19	60	57	22	M16	UC309 UC309-26 UC309-27 UC309-28	F309	3.40
UCF310 310-29 310-30 310-31	50 1-13/16 1-7/8 1-15/16	175	132	28	19	48	23	67	61	22	M20	UC310 UC310-29 UC310-30 UC310-31	F310	4.50
UCF311 311-32 311-33 311-34 311-35	55 2 2-1/16 2-1/8 2-3/16	185	140	30	20	52	23	71	66	25.0	M20	UC311 UC311-32 UC311-33 UC311-34 UC311-35	F311	5.50
UCF312 312-36 312-37 312-38 312-39	60 2-1/4 2-5/16 2-3/8 2-7/16	195	150	33	22	56	23	78	71	26.0	M20	UC312 UC312-36 UC312-37 UC312-38 UC312-39	F312	6.50
UCF313 313-40 313-41	65 2-1/2 2-9/16	208	166	33	22	58	23	78	75	30	M20	UC313 UC313-40 UC313-41	F313	7.90
UCF314 314-42 314-43 314-44	70 2-5/8 2-11/16 2-3/4	226	178	36	25	61	25	81	78	33	M22	UC314 UC314-42 UC314-43 UC314-44	F314	9.60
UCF315 315-45 315-46 315-47 315-48	75 2-13/16 2-7/8 2-15/16 3	236	184	39	25	66	25	89	82	32.0	M22	UC315 UC315-45 UC315-46 UC315-47 UC315-48	F315	11.00
UCF316 316-49 316-50 316-51	80 3-1/16 3-1/8 3-3/16	250	196	38	27	68	31	90	86	34	M27	UC316 UC316-49 UC316-50 UC316-51	F316	13.30
UCF317 317-52 317-53 317-54	85 3-1/4 3-5/16 3-7/16	260	204	44	27	74	31	100	96	40	M27	UC317 UC317-52 UC317-53 UC317-54	F317	15.30
UCF318 318-55 318-56	90 3-7/16 3-1/2	280	216	44	30	76	35	100	96	40	M30	UC318 UC318-55 UC318-56	F318	18.60
UCF319 319-58 319-59 319-60	95 3-5/8 3-11/16 3-3/4	290	228	59	30	94	35	121	103	41	M30	UC319 UC319-58 UC319-59 UC319-60	F319	22.80
UCF320 320-64	100 4	310	242	59	32	94	38	125	108	42	M33	UC320 UC320-64	F320	26.10
UCF322	110	340	266	60	35	96	41	131	117	46	M36	UC322	F322	34.90
UCF324	120	370	290	65	40	110	41	140	126	51	M36	UC324	F324	46.80
UCF326	130	410	320	65	45	115	41	146	135	54	M36	UC326	F326	62.60
UCF328	140	450	350	75	55	125	41	161	145	59	M36	UC328	F328	85.50